

CENTRAL OHIO'S LARGEST NEUTRAL DATA CENTER - COL3 IS NOW OPEN -

160K SQF • 20MW • Hyper Secure • High Density Cloud & Network Hub



Cologix is the Best Option for Enterprises to Tap into Carrier & Cloud Connectivity in Central Ohio.

The new \$130M+ facility is the largest neutral data center in the region and is directly linked to Cologix's existing data centers (COL1 & COL2). COL3 has been awarded the coveted Tier III certification of Constructed Facility ensuring that the data center has been constructed as designed, and verifies that it is capable of meeting the defined availability requirements.

Cologix designed the site with the most sophisticated cloud providers and enterprises in mind. The data center is concurrently maintainable, and offers scalable power solutions. Further unique attributes include an EF-4 tornado rating, K-rated perimeter fence and 24x7 guards. The redundancy, scale, security and connectivity enables Cologix to uniquely address growing market demand ranging from individual cabinets to multi-megawatt deployments.

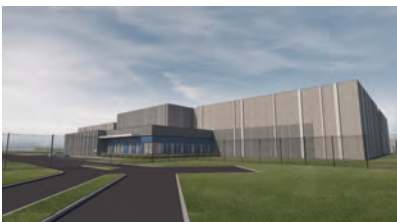

Space:

- 160K SQF Building
- EF-4 Tornado Rated
- K-Rated Fence

Configuration:

- 4 Data Halls - Up to 20 MW
- Each Data Hall is:
 - 20K SQF
 - 3MW
 - 2N Electrical
 - N+1 Mechanical
 - 72 Hours of Fuel
 - Pursuing Tier III Certification

Security:

- Hyper Secure
 - Biometric Scanners and Badges
 - Anti-Intrusion System
 - Tail-gate Proof Man Traps
 - 24x7 Security
 - Closed Circuit TV

Connectivity:

- Most connected Data Center campus in Ohio
- Access to 40+ Carriers, ISPs, ASP's & connectivity to the OHIO-IX internet exchange
- Low latency access to AWS Direct Connect Node located on campus

Cologix is the Best Option for Enterprises to Tap into Carrier & Cloud Connectivity in Central Ohio

Enterprises are increasingly future-proofing their businesses by ensuring broad choice and low switching costs, the central tools to find the right suppliers, reduce costs and flexibility to adapt to changing technology and vendor sets.

No other data center provider can match the choice of service providers available in Cologix's Columbus data center.

We provide Columbus Customers:

- ☒ Comprehensive, customizable, colocation solutions
- ☒ Network Neutral choice of 50+ Carriers
- ☒ Neutral choice of 30+ public, private & hybrid Cloud service providers including low latency access to the Amazon Web Services Direct Connect Node located on campus.

cologix

sales@cologix.com

1.855.265.6449

SITE SPECIFICATIONS: COL 3: 585 Scherers Court

Information based on preliminary designs

Site Information

Columbus 3 Space:	160,000 SQF Campus
Total COL Campus:	200,000+ SQF purpose-built facilities on 8 acre campus
Space Configuration:	4 Data Halls – Up to 20 MW
Floor Type:	24" raised floor with anti-static tiles
Loading Capacity:	150 Lbs/SQF floor loading with dedicated, sunken loading deck
Roof Rights:	Available on individual case basis

Site Structure

Year Built:	2016
Number of Floors:	2 floor with disaster recovery mezzanine
Structure Type:	Poured concrete structure, Double membrane roof structure
Exterior Type:	Pre-cast panel exterior walls capable of handling flying debris and ballistic testing
Environmental Rating:	EF-4 Tornado Rated
Flood Plain:	No flood plain rating in geographic high point of region
Ceiling Clearance:	19' interior deck-to-deck clearance

Security

Accreditations:	Uptime Tier III certification of Constructed Facility Pursuing SOC 1 (SSAE18/ISAE3402) Type 2 & SOC 2 Type 2 attestation reports
Perimeter:	K-Rated fence
Systems:	Anti-Intrusion
Closed-Circuit TV:	CCTV with recordings kept for 90 days
Customized Security:	Yes, per client requirements
On-site Staffing:	24/7 with around-the-clock rounds
Access:	Biometric Scanners & Badges
Man Traps:	Yes

Environmental Controls

Cooling Distribution:	Raised floor cold air plenum supply; return air plenum
Cooling Capacity:	770 tons per Data Hall
Cooling Type:	Liebert, Pump refrigerant DSE
Redundant:	Concurrently Maintainable, A & B systems
Humidification:	Yes, Centralized systems

Fire Protection

Fire Protection:	Multi Zone,
Fire Suppression:	Pre-action systems, multi-stage, zoned & localized dry pipe
Remotely Monitored:	Yes

Connectivity

Meet-Me-Room:	Yes, Cologix controlled
Number of Networks:	50+ unique networks. Access to AWS Direct Connect
Network Neutral:	Yes
IP Service:	Managed BGP IP (IPv4 & IPv6); multi carrier blend with quad-redundant routers & Cologix provided customer AS
Fiber Entrance:	numbers & IP space
Fiber Cross Connects:	Redundant
Copper Cross Connects:	Yes
Other:	Yes

Power

Uninterruptible Power Supply (UPS):	Four (4) 750 kVA Mitisbushi UPS systems per data hall, per side- Paralleled systems
Load Design:	5 kW per Cabinet
Configurations:	2N Electrical, N+1 Mechanical
Entrances:	2N diverse feeds from discrete substations
Battery Monitoring:	Canara intelligent battery monitoring
Power Buses:	Redundant parallel IEM power bus systems serve functionality and eliminate all single points of failure
Backup Generators:	2N generator configuration- Two (2) MW Caterpillar side A and Two (2) MW Caterpillar side B
Fuel Run-Time:	On-site fuel capacity for 72 hours run time at full load
Remotely Monitored:	Yes, Cologix Command
Facility Rating:	Redundant 48,000 Gallon tanks on-site, Priority refueling from diverse supplies & facility exemption from emergency power

Site Utility

Electric:	30 MW utility available on campus
Power Feed Source:	AEP Ohio
Redundant Power:	Alternative Feed Service (AFS)
Power from Substation:	2N diverse feeds from discrete substations

Customer Support

Remote Hands:	Yes, 24/7
Customer Support:	+1.855.449.4357 option 6, or Support@Cologix.com
Sales:	Sales@Cologix.com or +1.855.497.2537

24 Network Neutral Data Centers Throughout North America

Columbus - Dallas - Jacksonville - Lakeland - Minneapolis - Montreal - New Jersey - Toronto - Vancouver



Sales@cologix.com | 1.855.497.2537 | www.cologix.com

